



SURFACE  
HINGES





SURFACE  
HINGE  
WX



# SURFACE HINGES WX - ASYMETRICAL 2 - WING



7016



7024



8077



8017



9001



9010



7035



ANODE NATURAL



RAL



GOLD W3



GOLDEN OAK



C-35 ANODE BLACK F40



PLASTIC BLACK



7021



9005



8019



8003



1036W



9016



9006



INOX COATED



GOLDEN ELECTROPOLER



GOLD W4









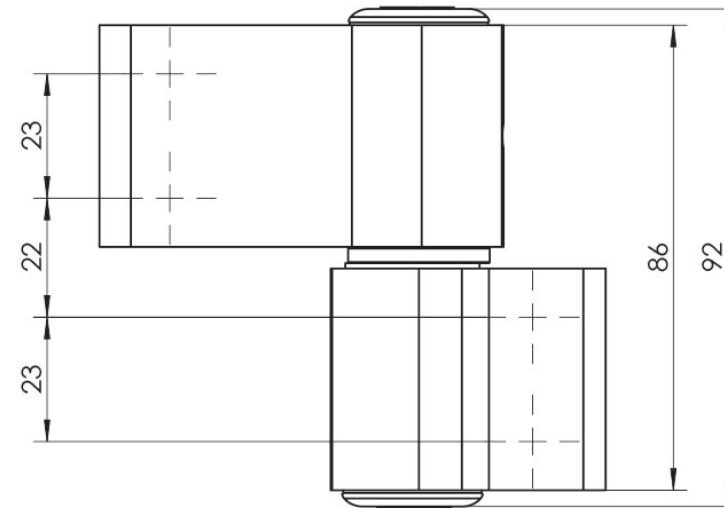
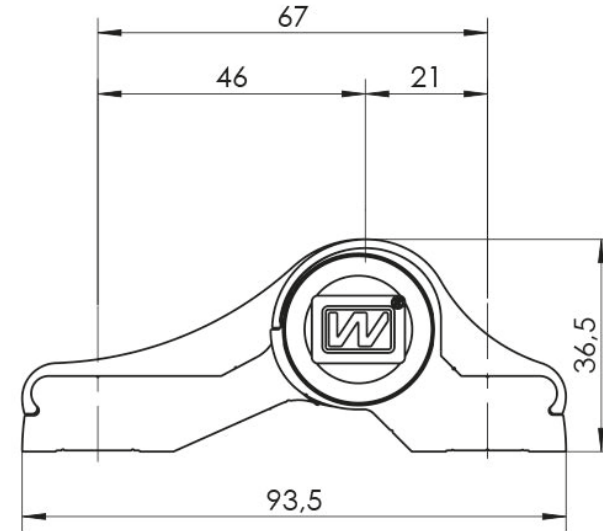

WALNUT

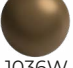

PLASTIC WHITE



# SURFACE HINGES WX - ASYMETRICAL 3 - WING

- |  |   |
|--|---|
|    |    |
| 7016   | 7021  |
|    |    |
| 7024   | 9005  |
|    |    |
| 8077   | 8019  |
|    |    |
| 8017   | 8003  |
|    |    |
| 9001   | 1036W   |
|    |    |
| 9010   | 9016  |
|    |    |
| 7035   | 9006  |
|    |    |
| ANODE NATURAL  | INOX COATED   |
|  |  |
| RAL  | GOLDEN ELECTROPOLER   |
|  |  |
| GOLD W3  | GOLD W4   |
|  |  |
| GOLDEN OAK   | WALNUT  |
|  |   |
| C-35 ANODE BLACK F40   |   |
|  |  |
| PLASTIC BLACK  | PLASTIC WHITE   |

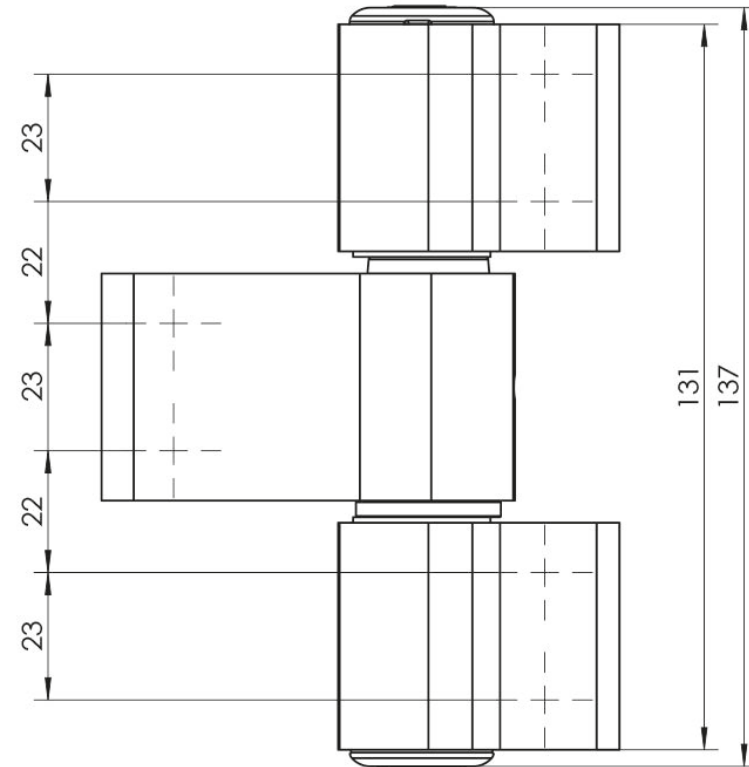
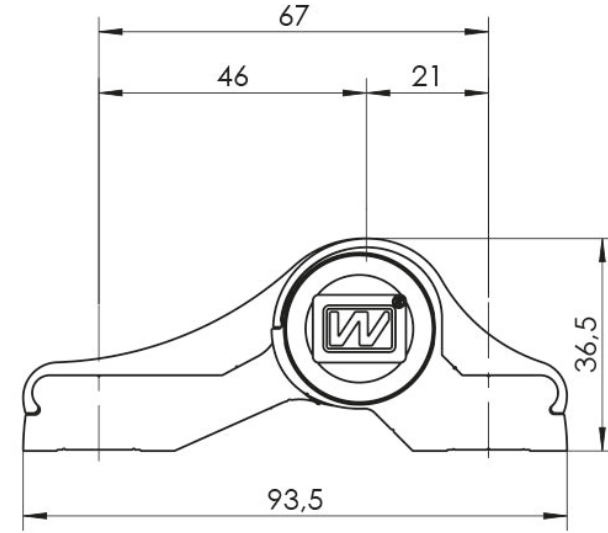

# SURFACE HINGES WX - SYMETRICAL 2 - WING



7016

7021



7024



9005



8077



8019



8017



8003



9001



1036W



9010



9016



7035



9006



ANODE  
NATURAL



INOX  
COATED



RAL



GOLDEN  
ELECTROPOLER



GOLD W3



GOLD W4



GOLDEN OAK



WALNUT



C-35 ANODE  
BLACK F40



PLASTIC  
BLACK



PLASTIC  
WHITE

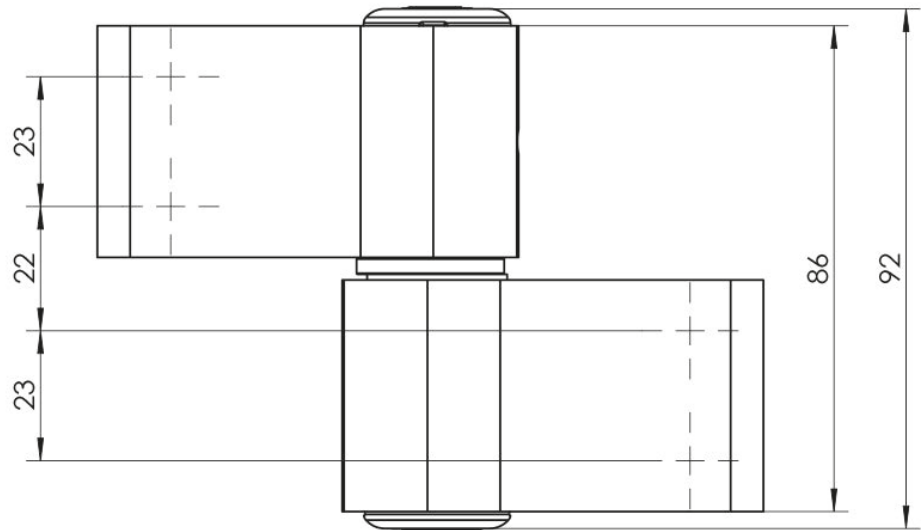
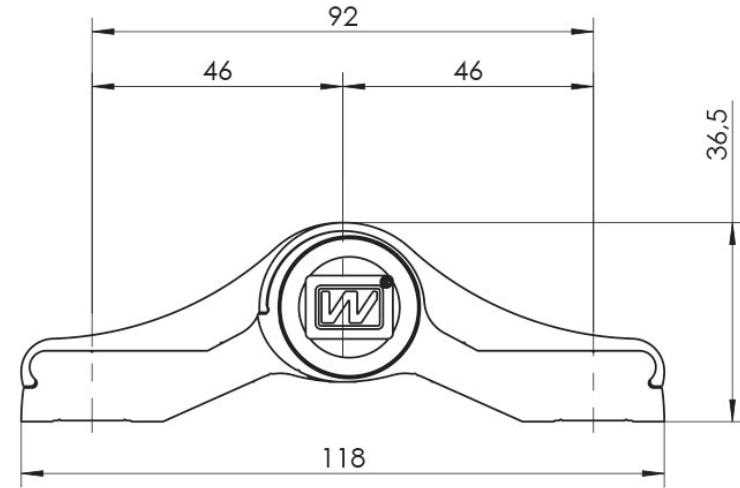

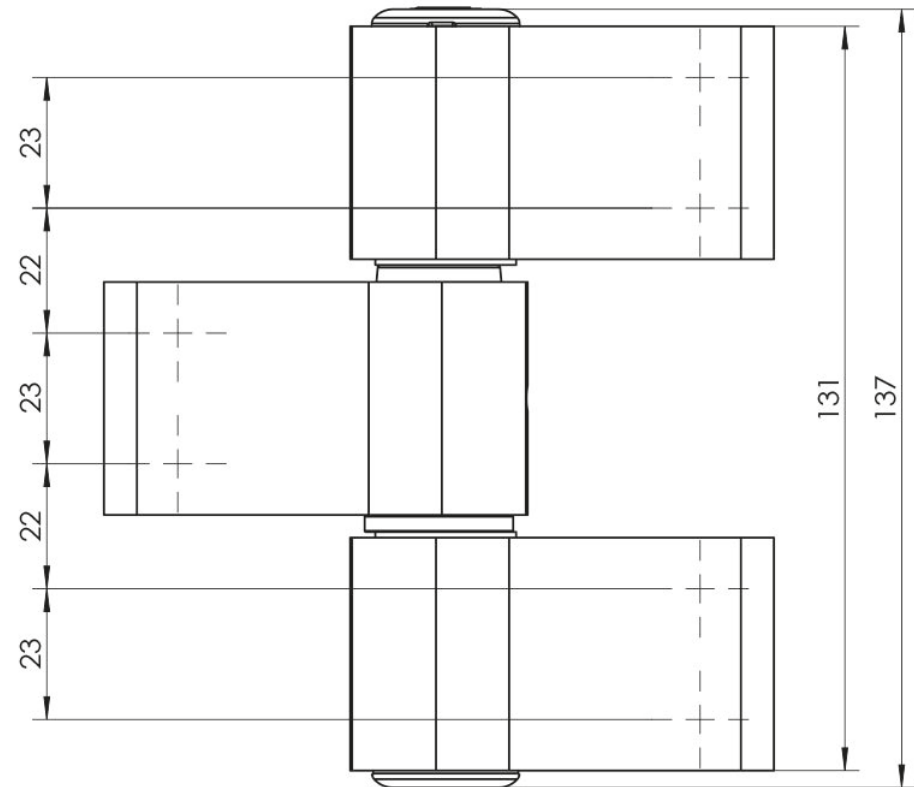
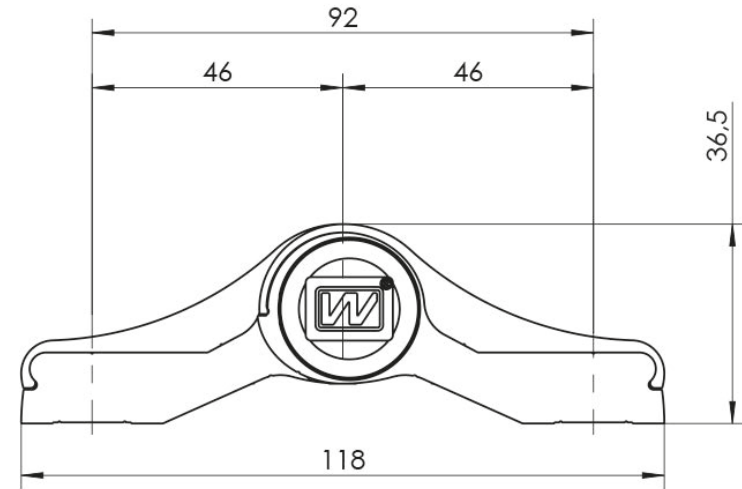

# SURFACE HINGES WX - SYMETRICAL 3 - WING

- |  |   |
|--|---|
|    |    |
| 7016   | 7021  |
|    |    |
| 7024   | 9005  |
|    |    |
| 8077   | 8019  |
|    |    |
| 8017   | 8003  |
|    |    |
| 9001   | 1036W   |
|    |    |
| 9010   | 9016  |
|    |    |
| 7035   | 9006  |
|    |    |
| ANODE NATURAL  | INOX COATED   |
|  |  |
| RAL  | GOLDEN ELECTROPOLER   |
|  |  |
| GOLD W3  | GOLD W4   |
|  |  |
| GOLDEN OAK   | WALNUT  |
|  |   |
| C-35 ANODE BLACK F40   |   |
|  |  |
| PLASTIC BLACK  | PLASTIC WHITE   |



# SURFACE HINGES WX - ANGULAR 2 - WING

- |  |   |
|--|---|
|    |    |
| 7016   | 7021  |
|    |    |
| 7024   | 9005  |
|    |    |
| 8077   | 8019  |
|    |    |
| 8017   | 8003  |
|    |    |
| 9001   | 1036W   |
|    |    |
| 9010   | 9016  |
|    |    |
| 7035   | 9006  |
|    |    |
| ANODE NATURAL  | INOX COATED   |
|  |  |
| RAL  | GOLDEN ELECTROPOLER   |
|  |  |
| GOLD W3  | GOLD W4   |
|  |  |
| GOLDEN OAK   | WALNUT  |
|  |   |
| C-35 ANODE BLACK F40   |   |
|  |  |
| PLASTIC BLACK  | PLASTIC WHITE   |

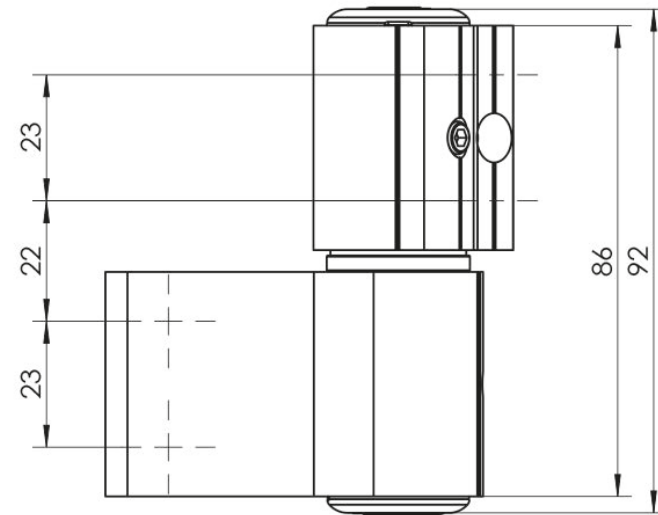
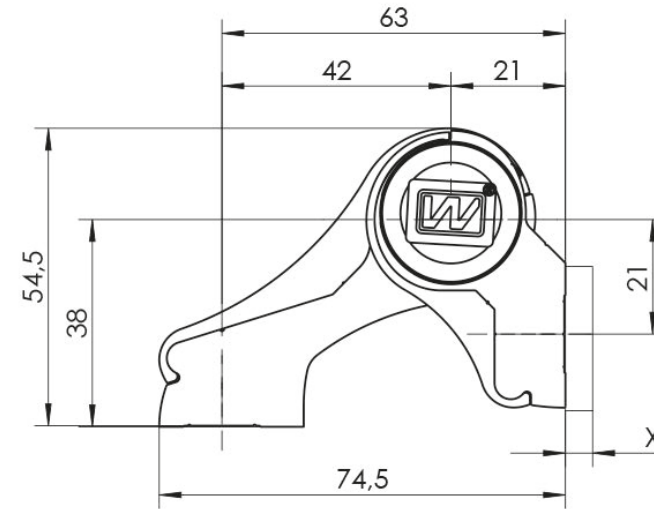

# SURFACE HINGES WX - ANGULAR 3 - WING

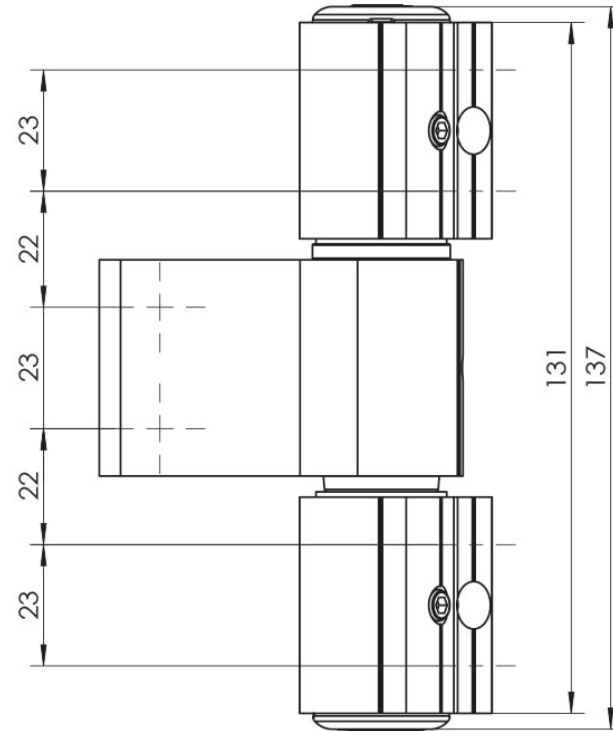
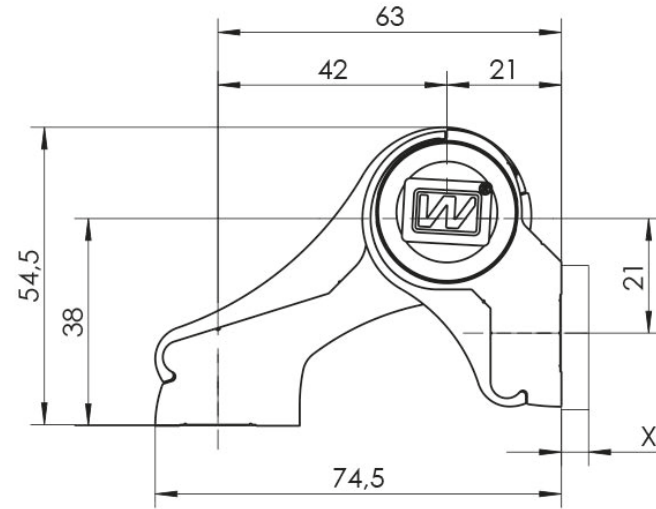
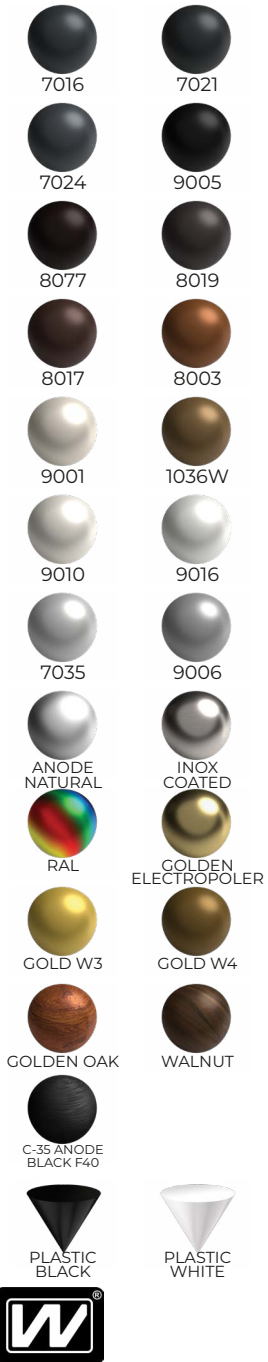



# SURFACE HINGES WX

FOR USE IN FIRE DOOR AND EMERGENCY EXIT DOORS

## WX HINGE CLASSIFICATION EN 1935:2002 + EN 1935:2002/AC:2003

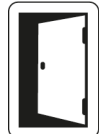

4/4 - SERVICE CLESSES



7/7 - DURABILITY

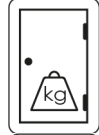

7/7 - WEIGHT OF TEST DOOR



1/1 - FIRE RESISTANCE



1/1 - SECURITY



4/4 - CORROSION RESISTANCE

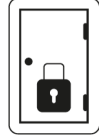

1/1 - INTRUSION PROTECTION

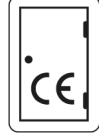

14/14 - HINGE CLASS





ASSEMBLY ELEMENTS  
OF A DOOR FRAME



ASSEMBLY ELEMENTS  
OF A DOOR SASH



ASSEMBLY ELEMENTS  
OF A DOOR FRAME



ASSEMBLY ELEMENTS  
OF A DOOR SASH

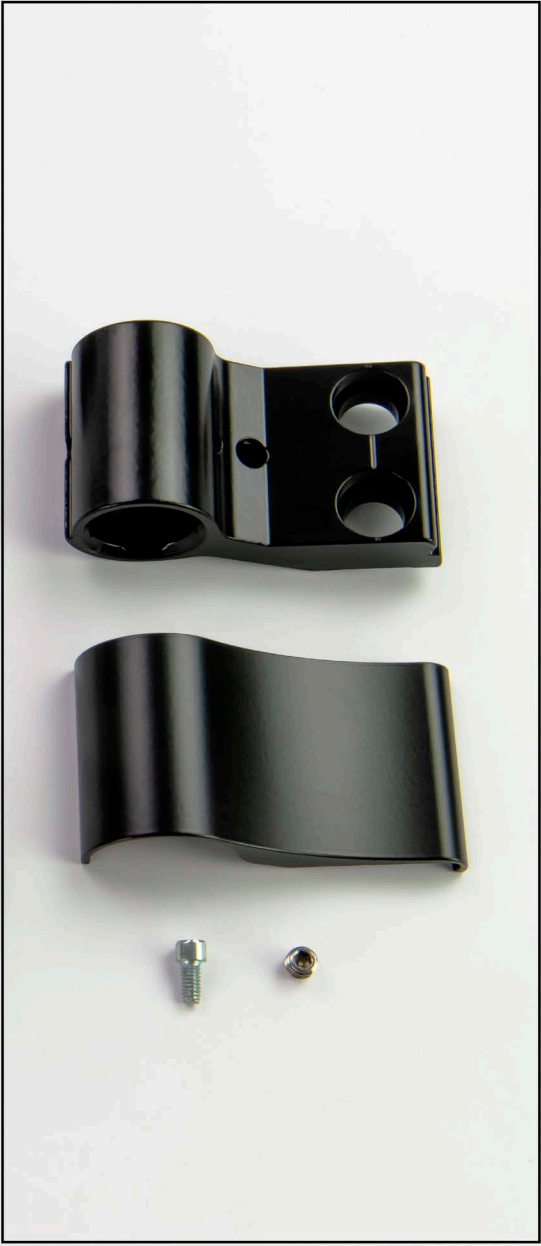

# MOUNTING SETS FOR SURFACE HINGES WX

\* mounting available in stainless and INOX variants



MOUNTING SETS FOR PROFILE WITH THERMAL BARRIER (WARM)









WX80104720	WX80104980	WX80105100	WX80SD4980 (INOX)*	WX80SD5100 (INOX)*	WX80SD5000	WX80SD5120	WX80SD5220	WX80DU5120 (INOX)*	WX80DU5220 (INOX)*
4 x M8X53 screw 4 x positioning sleeve 4 x adjusting sleeve (22-35mm) 2 x WN block	4 x M8X53 screw 4 x short positioning sleeve 4 x dowel sleeve TKO 48mm	4 x M8x65 screw 4 x positioning sleeve 4 x dowel sleeve TKO fire bushing 64mm	4 x quick-fastening screw 58,5mm	4 x quick-fastening screw 71,5mm	4 x long quick-fastening screw 84,5mm	2 x M8x33 screw 2 x positioning sleeve 1 x WN block 2 x quick-fastening screw 58,5mm	2 x M8x33 screw 2 x positioning sleeve 1 x WN block 2 x quick-fastening screw 71,5mm	2 x positioning screw 1 x WN block 2 x quick-fastening screw 58,5mm	2 x positioning screw 1 x WN block 2 x quick-fastening screw 71,5mm

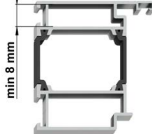



WX80104730	WX80104990	WX80105110	WX80SD4990 (INOX)*	WX80SD5110 (INOX)*	WX80SD5001	WX80SD5130	WX80SD5230	WX80DU5130 (INOX)*	WX80DU5230 (INOX)*
6 x M8x53 screw 6 x positioning sleeve 6 x adjusting sleeve 1 x WN block 1 x long WN block	6 x M8x53 screw 6 x short positioning sleeve 6 x dowel sleeve TKO 48mm	6 x M8x65 screw 6 x positioning sleeve 6 x dowel sleeve TKO fire bushing 64mm	6 x quick-fastening screw 58,5mm	6 x long quick-fastening screw 71,5mm	6 x long quick-fastening screw 84,5mm	4 x M8x33 screw 4 x positioning sleeve 1 x long WN block 2 x quick-fastening screw 58,5mm	4 x M8x33 screw 4 x positioning sleeve 1 x long WN block 2 x quick-fastening screw 71,5mm	4 x positioning screw 1 x long WN block 2 x quick-fastening screw 58,5mm	4 x positioning screw 1 x long WN block 2 x quick-fastening screw 71,5mm

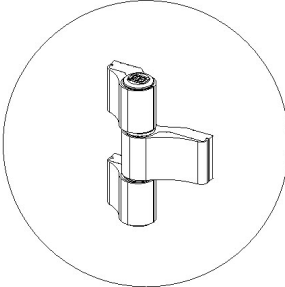
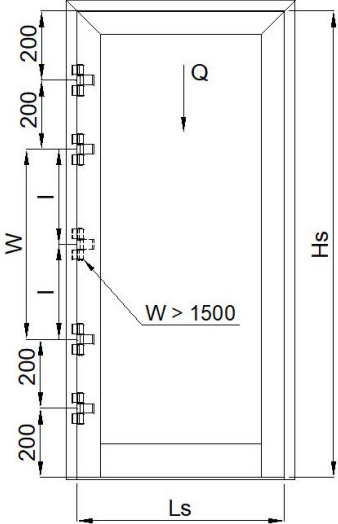

# MOUNTING SETS FOR SURFACE HINGES WX

\* mounting available in stainless and INOX variants

PROFILE WITHOUT THERMAL BARRIER (COLD)				PROFILE WITH NARROW THERMAL BARRIER (WARM) FROM THE HINGE SIDE (AT LEAST 8mm WIDTH)			
							
<b>WX80SU4700 (INOX)*</b>	<b>WX80104700</b>	<b>WX80SU4710 (INOX)*</b>	<b>WX80104710</b>	<b>WX80SU4900 (INOX)*</b>	<b>WX80104900</b>	<b>WX80SU4910 (INOX)*</b>	<b>WX80104910</b>
							
4 x positioning screw 2 x WN block	4 x M8x25 screw 4 x positioning sleeve 2 x WN block	6 x positioning screw 1 x WN block 1 x WN long block	6 x M8x25 screw 6 x positioning sleeve 1 x WN block 1 x WN long block	4 x positioning screw 2 x WKU block	4 x M8x25 screw 4 x positioning sleeve 2 x WKU block	6 x positioning screw 3 x WKU block	6 x M8x25 screw 6 x positioning sleeve 3 x WKU block

MOUNTING SETS-BIG PACK					
<b>WX50SU4700</b>	<b>WX50SD4980</b>	<b>WX50SD5100</b>	<b>WX50SD5000</b>		
					
Positioning screw: 200pcs. WN block: 100pcs.	Quick-fastening screw 58,5mm: 200pcs.	Quick-fastening screw 71,5mm: 200pcs.	Quick-fastening screw 84,5mm: 200pcs.		



# LOAD SELECTION SURFACE HINGES WX

If the distance between hinges in the middle of a door exceeds 1500mm, we suggest using additional hinge which caulks the door.

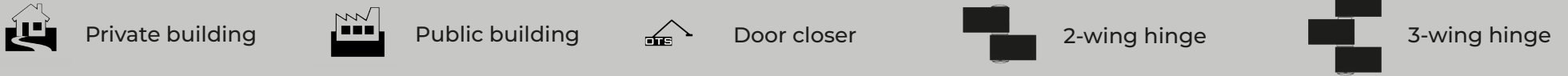

**2x**

W	S	800	900	1000	1100	1200	1300	1400
2000		122	113	105	97	90	83	77
2100		129	119	110	102	95	88	81
2200	130	125	116	107	99	92	85	78
2300								
2400	130	128	118	109	101	94	87	80
2500								
2600	130	124	115	106	99	92	85	78
2700								
2800	130	127	117	109	102	95	88	81
2900								
3000	130	123	114	106	99	92	85	78
3000								

**3x**   **2x**

W	S	800	900	1000	1100	1200	1300	1400
2000		173	160	148	137	127	117	109
2100	180	168	155	144	133	123	114	106
2200								
2300	180	176	163	151	140	130	120	112
2400								
2500	180	171	159	147	136	126	117	109
2600								
2700	180	167	154	143	132	122	113	105
2800								
2900	180	175	162	150	139	128	119	110
3000								
3000	180	170	157	146	135	124	115	106
3000								
3000	180	179	165	153	142	131	121	112
3000								
3000	180	174	161	149	138	127	117	108
3000								
3000	180	169	156	144	133	122	112	103
3000								
3000	180	169	156	144	133	122	112	103
3000								

**3x**

W	S	800	900	1000	1100	1200	1300	1400
2000		216	200	185	171	159	147	136
2100	220	210	194	180	167	154	143	132
2200								
2300	220	204	189	175	162	150	139	128
2400								
2500	220	214	198	184	170	157	145	134
2600								
2700	220	208	193	179	165	152	140	129
2800								
2900	220	219	202	187	174	161	148	137
3000								
3000	220	213	197	182	168	155	143	132
3000								
3000	220	207	191	176	163	150	138	127
3000								
3000	220	217	201	186	173	160	148	137
3000								
3000	220	211	195	180	167	154	142	131
3000								
3000	220	220	204	188	174	161	149	138
3000								





**4x**

W	S	800	900	1000	1100	1200	1300	1400
2000		238	220	204	189	175	162	150
2100	250	249	231	214	198	183	170	158
2200								
2300	250	243	225	208	193	178	165	153
2400								
2500	250	236	218	202	187	172	159	147
2600								
2700	250	248	229	212	197	181	166	154
2800								
2900	250	241	223	206	190	174	159	147
3000								
3000	250	234	217	200	184	168	152	140
3000								
3000	250	246	228	210	194	177	161	149
3000								
3000	250	239	221	204	188	171	155	143
3000								
3000	250	246	228	210	194	177	161	149
3000								





# LOAD SELECTION SURFACE HINGES WX

If the distance between hinges in the middle of a door exceeds 1500mm, we suggest using additional hinge which caulks the door.

 Private building
  Public building
  Door closer
  2-wing hinge
  3-wing hinge

	W	S	800	900	1000	1100	1200	1300	1400
			<b>2x</b>	<b>140</b>	<b>140</b>	<b>140</b>	130	120	111
2100	137	126	117				108	100	
2200	133	123	114				105		
2300								139	129
2400	135	125	116						
2500							132	122	
2600									138
2700	140	140	140				134		
2800							140	140	140
2900	140	140	140						
3000							140	140	140

	W	S	800	900	1000	1100	1200	1300	1400		
			<b>3x</b> <b>2x</b>	<b>200</b>	<b>200</b>	198	184	170	157	146	135
2100	193	179	165			153	142	131			
2200									187	174	161
2300	197	182	169			156	145				
2400								191	177	164	152
2500											
2600	195	181	167								
2700						200	200	200	190	176	
2800	200	200	200						199	185	
2900						200	200	200	200	194	
3000	200	200	200						200	200	

	W	S	800	900	1000	1100	1200	1300	1400	
			<b>3x</b>	<b>230</b>	<b>230</b>	<b>230</b>	216	200	185	171
2100	227	210	194				180	167	154	
2200	221	204	189				175	162		
2300									214	198
2400	225	208	193				179			
2500								219	203	188
2600										
2700	223	207	217							
2800							230	230	230	217
2900	230	230	230							228
3000							230	230	230	230

	W	S	800	900	1000	1100	1200	1300	1400			
			<b>4x</b>	<b>280</b>	<b>280</b>	<b>280</b>	259	240	222	206	191	176
2100	272	252	233				216	200	185			
2200										265	245	227
2300	278	257	238				221	204				
2400									270	250	232	214
2500												
2600	276	255	236									
2700							280	280	280	268	248	
2800	280	280	280							261		
2900							280	280	280	274		
3000	280	280	280							280		



# LOAD SELECTION SURFACE HINGES WX

If the distance between hinges in the middle of a door exceeds 1500mm, we suggest using additional hinge which caulks the door.

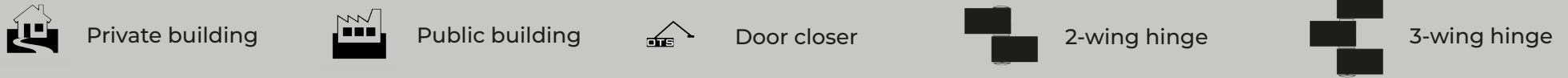

  <b>2x</b>	W	S	800	900	1000	1100	1200	1300	1400
	<b>2000</b>			98	91	84	78	72	67
<b>2100</b>			103	95	88	82	76	70	65
<b>2200</b>			108	100	93	86	79	74	68
<b>2300</b>			113	105	97	90	83	77	71
<b>2400</b>			119	110	102	95	88	81	75
<b>2500</b>			125	116	107	99	92	85	79
<b>2600</b>			<b>130</b>	122	113	104	97	89	83
<b>2700</b>				128	118	109	101	94	87
<b>2800</b>			<b>130</b>	<b>130</b>	124	115	106	99	91
<b>2900</b>					121	112	103	96	
<b>3000</b>					127	117	109	101	

  <b>3x</b> <b>2x</b>	W	S	800	900	1000	1100	1200	1300	1400
	<b>2000</b>			131	121	112	104	96	89
<b>2100</b>			137	127	118	109	101	93	86
<b>2200</b>			144	133	123	114	106	98	91
<b>2300</b>			151	140	130	120	111	103	95
<b>2400</b>			159	147	136	126	117	108	100
<b>2500</b>			167	154	143	132	123	113	105
<b>2600</b>			175	162	150	139	129	119	110
<b>2700</b>			<b>180</b>	170	158	146	135	125	116
<b>2800</b>				179	165	153	142	131	122
<b>2900</b>			<b>180</b>	174	161	149	138	128	
<b>3000</b>				180	169	156	145	134	

  <b>3x</b>	W	S	800	900	1000	1100	1200	1300	1400
	<b>2000</b>			169	157	145	134	124	115
<b>2100</b>			178	164	152	141	131	121	112
<b>2200</b>			186	173	160	148	137	127	118
<b>2300</b>			196	181	168	155	144	133	123
<b>2400</b>			206	190	176	163	151	140	130
<b>2500</b>			216	200	185	171	159	147	136
<b>2600</b>			<b>220</b>	210	194	180	167	154	143
<b>2700</b>				204	189	175	162	150	
<b>2800</b>			<b>220</b>	<b>220</b>	214	198	184	170	157
<b>2900</b>					208	193	179	165	
<b>3000</b>					219	202	187	174	

  <b>4x</b>	W	S	800	900	1000	1100	1200	1300	1400
	<b>2000</b>			219	203	188	174	161	149
<b>2100</b>			230	213	197	183	169	157	145
<b>2200</b>			242	224	207	192	178	165	152
<b>2300</b>			<b>250</b>	235	218	202	187	173	160
<b>2400</b>				247	229	212	196	181	168
<b>2500</b>			<b>250</b>	<b>250</b>	240	222	206	190	176
<b>2600</b>					233	216	200	185	
<b>2700</b>			<b>250</b>	<b>250</b>	245	227	210	194	
<b>2800</b>					238	220	204		
<b>2900</b>			<b>250</b>	<b>250</b>	232	214			
<b>3000</b>					243	225			





# ADJUSTMENT FOR SURFACE HINGES WX

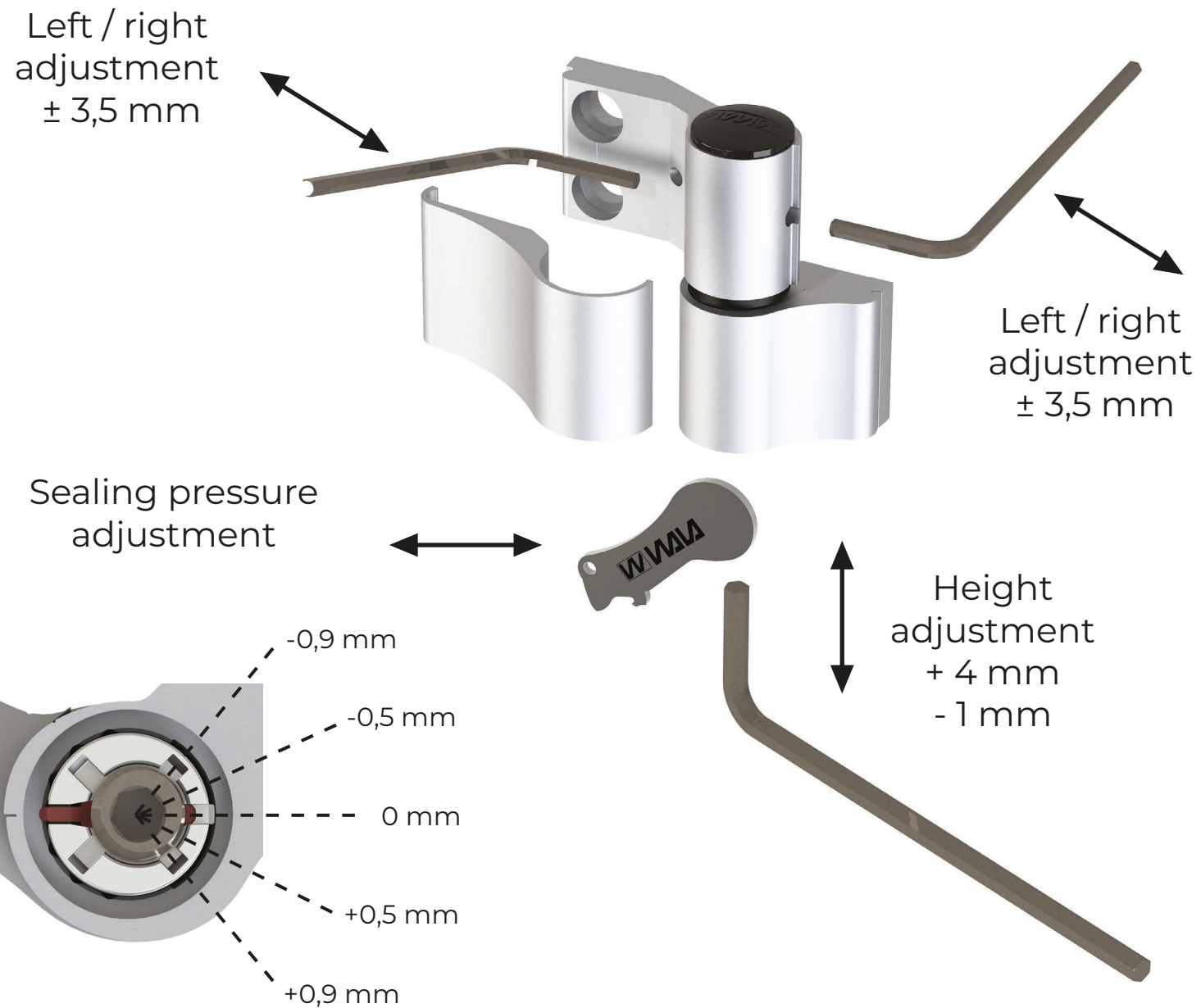

# PATTERNS FOR DRILLING SURFACE HINGES WX

S1



S2

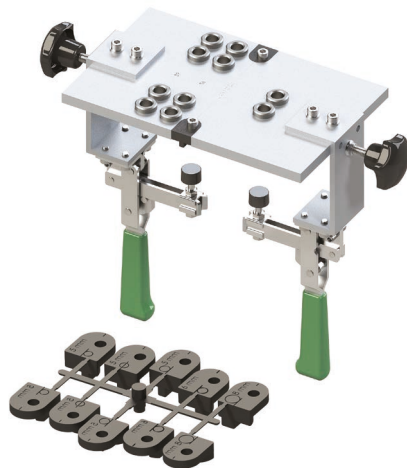

S3

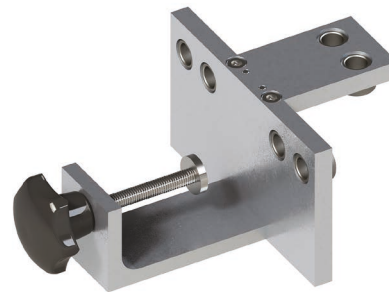

WX DISTANCE PLATE



THICKNESS [A]

2mm

3mm

5mm

8mm

10mm

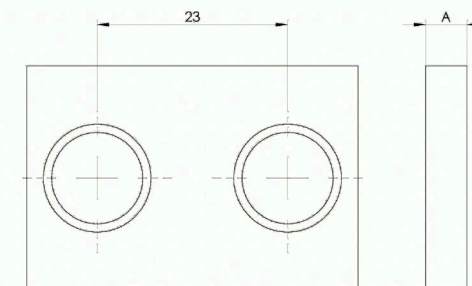
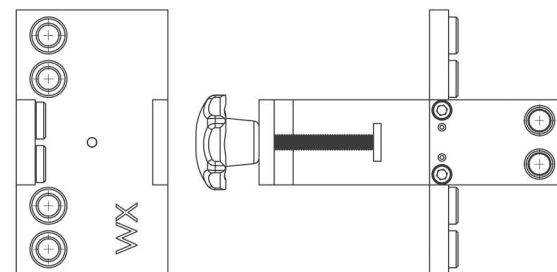
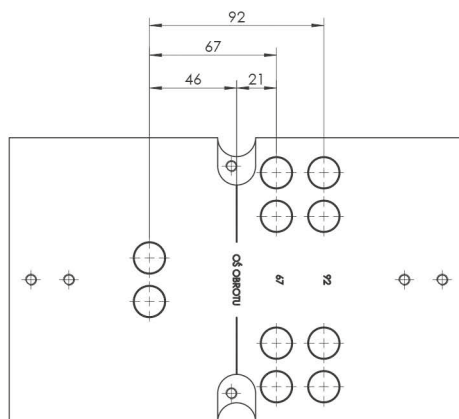
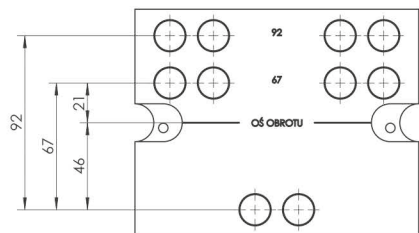

S1 Pattern for WX and MX Surface Hinge,  
dimension 67/92

S2 Pattern for WX and MX Surface Hinge,  
dimension 67/92

S3 Pattern for WX Angular Hinge

Plate must be select for suitable  
mounting set





SURFACE  
HINGE  
ELECTRO  
WX



# SURFACE HINGES WX ELECTRO

WX ELECTRO Hinge is intended to transfer ICT signals from the door frame to the door leaf. The signal can be transmitted via a 3-core cable with a cross-section of 0.5 or a 10-core cable with a cross-section of 0.14. Thanks to this, it is suitable for LAN computer networks, to supply LED lighting or handles with e-line components, replacing commonly used cable glands.

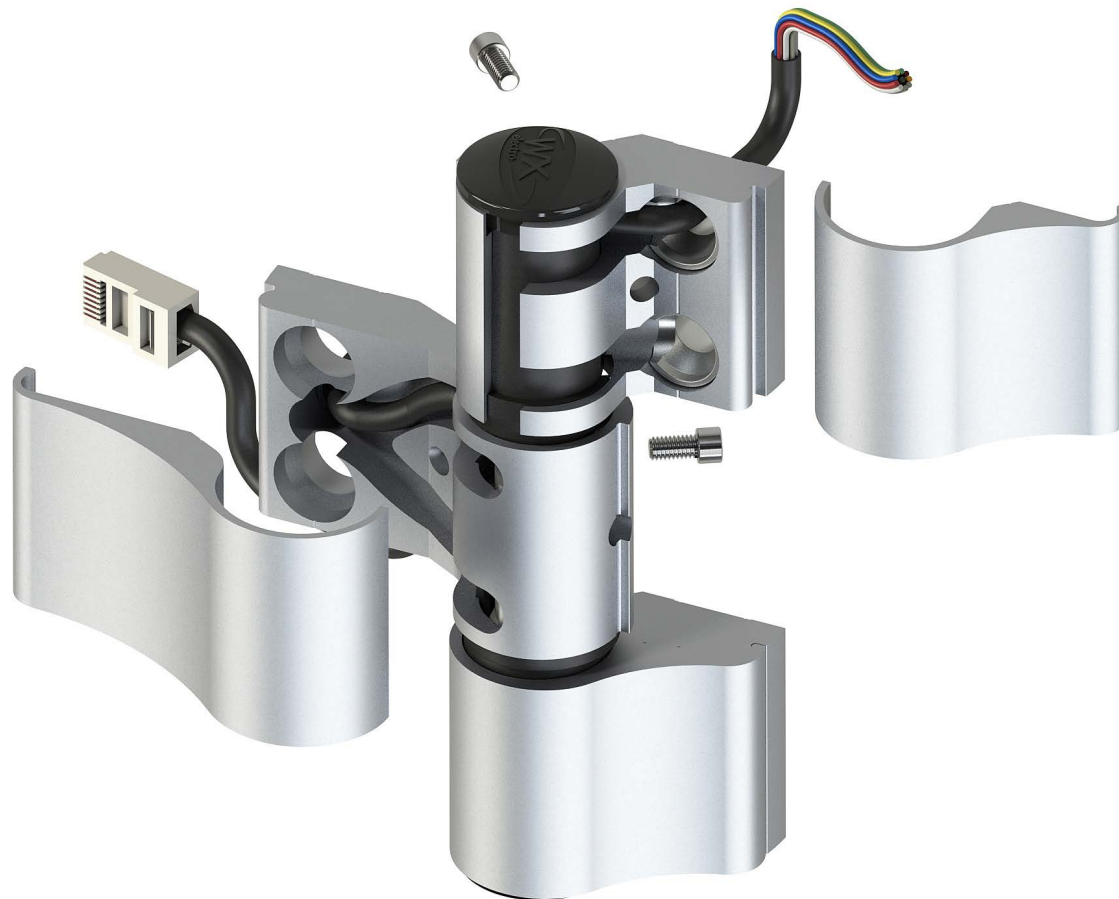

- |                      |                     |
|----------------------|---------------------|
|                      |                     |
| 7016                 | 7021                |
|                      |                     |
| 7024                 | 9005                |
|                      |                     |
| 8077                 | 8019                |
|                      |                     |
| 8017                 | 8003                |
|                      |                     |
| 9001                 | 1036W               |
|                      |                     |
| 9010                 | 9016                |
|                      |                     |
| 7035                 | 9006                |
|                      |                     |
| ANODE NATURAL        | INOX COATED         |
|                      |                     |
| RAL                  | GOLDEN ELECTROPOLER |
|                      |                     |
| GOLD W3              | GOLD W4             |
|                      |                     |
| GOLDEN OAK           | WALNUT              |
|                      |                     |
| C-35 ANODE BLACK F40 |                     |
|                      |                     |
| PLASTIC BLACK        | PLASTIC WHITE       |

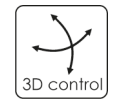

# SURFACE HINGES WX ELECTRO

FOR USE IN EMERGENCY EXIT DOORS

## WX ELECTRO HINGE CLASSIFICATION EN 1935:2002 + EN 1935:2002/AC:2003

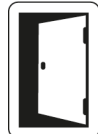

4/4 - SERVICE CLESSES



7/7 - DURABILITY

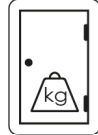

7/7 - WEIGHT OF TEST DOOR



0/1 - FIRE RESISTANCE



1/1 - SECURITY



3/4 - CORROSION RESISTANCE

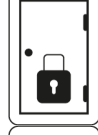

1/1 - INTRUSION PROTECTION

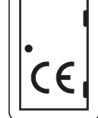

14/14 - HINGE CLASS



# MOUNTING SETS FOR HURFACE HINGES WX ELEKTRO

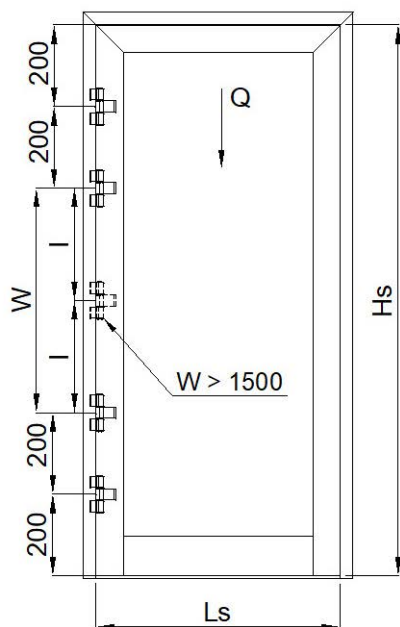
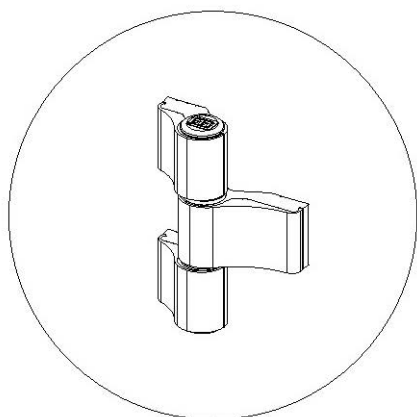

PROFILE WITHOUT THERMAL BARRIER (COLD)		MOUNTING SETS FOR PROFILE WITH THERMAL BARRIER (WARM)	
<b>WX80104710E</b>	<b>WX80SU4710E</b>	<b>WX80SD4990E (INOX)</b>	<b>WX80104990E</b>
5 x M8x25 screw 5 x positioning sleeve 1 x WN block electro 1 x long WN block	5 x positioning screw 1 x WN block electro 1 x long WN block	5 x quick- fastening screw 58,5mm	5 x M8x53 screw 5 x positioning sleeve 5 x dowel sleeve TKO



**WALA Sp. z o.o.**  
**ul. Parkowa 16**  
**43-365 Wilkowice**

**wala@wala.pl**  
**tel. +48 33 82 72 390**  
**kom. +48 725 70 80 30**  
**www.wala.pl**

